

Danfoss LX Electric Floor Heating Cable

Danfoss LX

Danfoss LX

BRINGING WARMTH TO LIFE

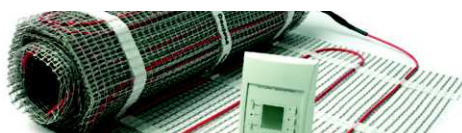

General Information

Danfoss LX Electric Floor Heating Cable Systems combine the highest comfort levels with maximum energy efficiency. Our Electric Floor Heating Cable Systems offer the following features: Flexible, **TWIN CONDUCTOR**, Single Point Connection, Easy to Install, Zero EMFs, **GFCI** protection, 10-Year Warranty.

Technical Data LX Cable



Cable construction:	Twin conductor
Height:	1/8"
Rated Voltage:	120V, 208V, 240V
Rated Temperature:	120°C / 248°F
Conductor Insulation:	Teflon™
Outer Sheath:	PVC 105°C / 220°F
Warranty:	10 years



Installation

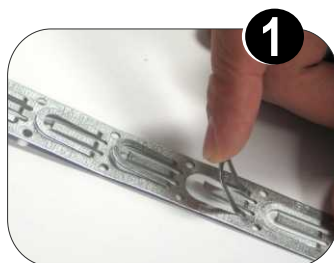

Attach The Danfoss LX Cable Strapping To The Subfloor (3' Apart)

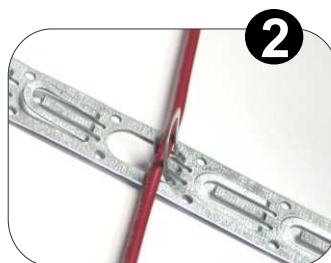

Place The LX Cable 2", 3", or 4" Apart Depending on Application.



Clip The LX Cable In Place Install Tiles/Floor Coverings

Ordering Information

LX Cable - 120V



	Part No.	Length (feet)	Approximate heat coverage (sq. ft.)			Amps	Watts (3W/ft)
			4" spacing	Standard 3" spacing	2" spacing		
blue	088L3140	40	15	10	7	1.0	120
red	088L3141	60	23	15	10	1.5	180
green	088L3142	80	30	20	13	2.0	240
yellow	088L3143	120	45	30	20	3.0	360
purple	088L3144	160	60	40	27	4.0	480
orange	088L3145	200	75	50	33	5.0	600
brown	088L3146	240	90	60	40	6.3	750

CONTROLS - SEE PG. 4
ACCESSORIES - SEE PG. 3

NOTE: Standard cable strapping is supplied with product. Additional cable strapping can be ordered separately. 2" centers provides 18W/sq.ft. 3" centers provides 12W/sq.ft., 4" centers provides 9W/sq.ft. Power leads are 10 feet in length. Contactors are required for loads exceeding 15 Amps on single thermostat - see pg.11.

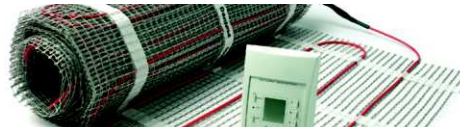

Ordering Information (cont'd)

LX Cable - 240V

	Part No.	Length (feet)	Approximate heat coverage (sq. ft.)			Amps	Watts (3W/ft)
			4" spacing	3" spacing	2" spacing		
A	088L3080	80	30	20	13	1.0	245
B	088L3081	120	45	30	20	1.5	365
B1	088L3082	160	60	40	27	2.0	480
C	088L3083	200	75	50	33	2.5	605
D	088L3084	240	90	60	40	3.0	725
D1	088L3085	280	105	70	47	3.5	840
E	088L3086	320	120	80	53	4.0	965
F	088L3087	360	135	90	60	4.5	1080
F1	088L3088	400	150	100	67	5.0	1200
F2	088L3089	440	165	110	73	5.5	1330
G	088L3090	480	180	120	80	6.0	1445
H	088L3091	570	210	140	93	7.1	1710
I	088L3092	630	240	160	107	8.0	1915



CONTROLS - SEE PG. 4
ACCESSORIES - BELLOW

NOTE: Standard cable strapping is supplied with product. Additional cable strapping spools can be ordered separately. 2" centers provides 18W/sq.ft. 3" centers provides 12W/sq.ft., 4" centers provides 9W/sq.ft. Watt output of the 240V cable is reduced by 25% when operated at 208V (approximately 2W/ft.). Power leads are 10 feet in length. Contactors are required for loads exceeding 15 Amps on single thermostat - see pg.11.

Accessories
LX mat and LX cable



Part No.	Description
088L1050	Cable strapping (15ft.)
088L1051	Cable strapping (75ft.)
088L3008	Replacement floor sensor for LX thermostat
088L0014	LX repair kit
19809099	Flexible conduit tube for LX floor sensor
088L0028	Little Buzzer - continuity alarm



NEW! LITTLE BUZZER - CONTINUITY ALARM

Simplify your installation process use Little Buzzer by Danfoss! The Little Buzzer is designed to monitor Danfoss heating mats and/or cable during installation process and sounds an alarm if the heating elements are cut. This allows an easy repair before the floor coverings are laid. The device is battery powered.

NOTE: Continuity alarm does not replace the need for measuring and verifying the Ohm resistance throughout the installation.